



# HOSHIZAKI

## Baker GA 550 L DR Retarder Prover



PRODUCT SERIES: BAKER 550  
ITEM NUMBER: 146551010  
COUNTRY OF ORIGIN: TURKEY

Hoshizaki BAKER GA 550 L DR is a retarder prover with individual program settings that can also operate as a storage refrigerator/freezer and a controlled thawing cabinet. It is for tray slides 400 x 600mm, has a gross volume of 480 ltr and a cabinet height of 2080-2130 mm. Legs are adjustable 130-180 mm.

- Multifunctionel cabinet
- Operates as a storage refrigerator/freezer, controlled thawing cabinet or retarder prover
- Air circulation system
- Automatic fan cut out switch
- Automatic defrost with re-evaporation of defrost water
- Heavy duty cabinet and compressor compartment construction
- Climate class 5 cooling system enduring up to +40°C ambient temperature
- Exterior and interior of stainless steel AISI 304
- Reversible and self closing door with lock
- Removable magnetic door gaskets with triple insulation area
- LED lighting
- 25 sets of bakery tray supports
- Pan-shaped inside base with rounded corners to catch fluids
- Pedal door opener with overload protection
- IP21 water protection

### ACCESSORIES INCLUDED

25 sets of bakery tray supports

### OPTIONAL EXTRAS

Set of legs 130-180 mm

Set of castors Ø100 mm

Grey shelf 1/1 EN with back upstand

Stainless shelf 1/1 EN with back upstand

Set (4 of) of stainless shelves 1/1 EN with back upstand

Shelf supports (2 of)

Master key

#### WARRANTY PERIOD

**6 Years on Parts & Labour -  
based on country agreement**

#### EXTERIOR

**Stainless steel AISI 304**

#### INTERIOR

**Stainless steel AISI 304**

Refrigerant type: R290 / GWP: 3 GWP / Refrigerant: 0,13 kg / CO2  
equivalent: 0,39 kg

#### CERTIFICATIONS





# HOSHIZAKI

## Baker GA 550 L DR

### TECHNICAL SPECIFICATIONS

Bakery tray size (mm)	Bakery tray insertion	Temperature range	Volume, gross	Power supply	Connection load	Climate class	Ref. capacity (at -30°C)
400 x 600	Longitudinal insertion	-25/+40°C	480 l	230V, 50Hz	1.400 W	5 (max. ambient 40°C w/ 40% RH)	491 W

### SHIPPING SPECIFICATIONS

Width (packed)	Depth (packed)	Height (packed)	Volume (packed)	Gross weight	Width	Depth	Height including legs (minimum)	Height including legs (maximum)	Net weight
700 mm	980 mm	2.270 mm	1,56 m <sup>3</sup>	140 kg	610 mm	895 mm	2.080 mm	2.130 mm	124 kg

Disclaimer: Every effort has been made to ensure that the information contained in this spec sheet is accurate at the time of publishing. Hoshizaki Europe BV assumes no responsibility or liability for typographical errors or omissions or for any misinterpretation of the information within the publication and reserves the right to change without notice.

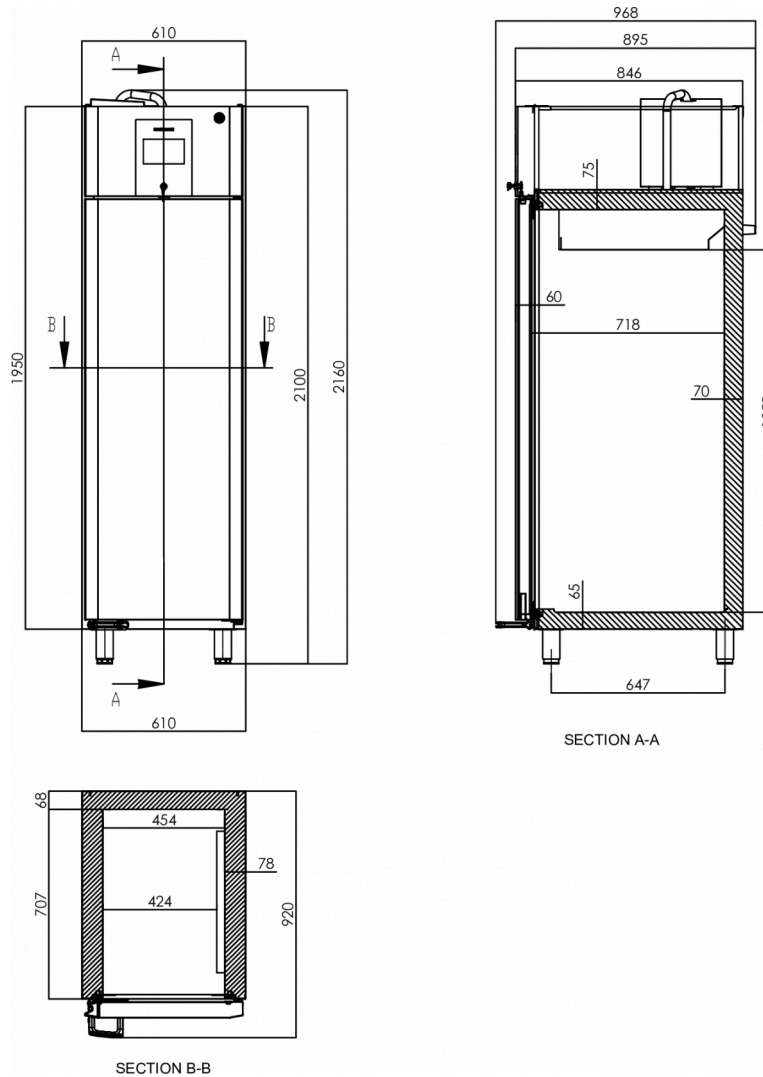

Hoshizaki Belgium  
Hoshizaki Danmark  
Hoshizaki Deutschland  
Hoshizaki France  
Hoshizaki Iberia  
Hoshizaki Italia  
Hoshizaki Middle East

[info@hoshizaki.nl](mailto:info@hoshizaki.nl)  
[info@hoshizaki.dk](mailto:info@hoshizaki.dk)  
[vertrieb@hoshizaki.de](mailto:vertrieb@hoshizaki.de)  
[info@hoshizaki.fr](mailto:info@hoshizaki.fr)  
[info@hoshizaki.es](mailto:info@hoshizaki.es)  
[commerciale@hoshizaki.it](mailto:commerciale@hoshizaki.it)  
[sales.ex@hoshizaki-europe.com](mailto:sales.ex@hoshizaki-europe.com)

Hoshizaki Netherlands [info@hoshizaki.nl](mailto:info@hoshizaki.nl)  
Hoshizaki Norge [salg@hoshizaki.no](mailto:salg@hoshizaki.no)  
Hoshizaki Sverige [order@hoshizaki.se](mailto:order@hoshizaki.se)  
Hoshizaki UK [uksales@hoshizaki.uk](mailto:uksales@hoshizaki.uk)  
Export countries [sales.ex@hoshizaki-europe.com](mailto:sales.ex@hoshizaki-europe.com)  
Other countries [sales.ex@hoshizaki-europe.com](mailto:sales.ex@hoshizaki-europe.com)

[www.hoshizaki-europe.com](http://www.hoshizaki-europe.com)