



HOSHIZAKI

Baker SF 950 L DR Quick Chiller/Freezer



PRODUCT SERIES: BAKER 950
ITEM NUMBER: 147951010
COUNTRY OF ORIGIN: TURKEY

Hoshizaki BAKER SF 950 L DR is a quick chiller/freezer that can also operate as a storage refrigerator/freezer and a controlled thawing cabinet. It is for tray slides 800 x 600 / 600 x 400 mm, has a gross volume of 950 ltr and a cabinet height of 2205-2255 mm. Legs are adjustable 130-180 mm.

- Operates as a quick chiller/freezer, storage refrigerator/freezer or as a controlled thawing cabinet
- Dry cooling function
- Air circulation system
- Automatic fan cut out switch
- Automatic defrost with re-evaporation of defrost water
- Heavy duty cabinet and compressor compartment construction
- Climate class 5 cooling system enduring up to +40°C ambient temperature
- Exterior and interior of stainless steel AISI 304
- RReversible and self closing door with lock
- Removable magnetic door gaskets with triple insulation area
- LED lighting
- 25 sets of bakery tray supports
- Pan-shaped inside base with rounded corners to catch fluids
- Pedal door opener with overload protection
- IP21 water protection

ACCESSORIES INCLUDED

25 sets of bakery tray supports

OPTIONAL EXTRAS

Set of legs 130-180 mm

Set of castors Ø100 mm

Grey shelf 800 x 600 mm with back upstand

Stainless shelf 800 x 600 mm with back upstand

Set (4 off) of stainless shelves 800 x 600 mm with back upstand

Set of wall rails (4) and tray supports (4) to allow for up to 27 bakery trays

Shelf supports, 2 of

Master key

WARRANTY PERIOD

**6 Years on Parts & Labour -
based on country agreement**

EXTERIOR

Stainless steel AISI 304

INTERIOR

Stainless steel AISI 304

Refrigerant type: R290 / GWP: 3 GWP / Refrigerant: 0.46 kg / CO2 equivalent: 1.38 kg

CERTIFICATIONS





HOSHIZAKI

Baker SF 950 L DR

TECHNICAL SPECIFICATIONS

Bakery tray size (mm)	Temperature range	Volume, gross	Power supply	Connection load	Climate class	Ref. capacity (at -30°C)
600 x 800 / 600 x 400	-30/+10°C	950 l	230V, 50Hz	1,700 W	5 (max. ambient 40°C w/ 40% RH)	1,348 W

SHIPPING SPECIFICATIONS

Width (packed)	Depth (packed)	Height (packed)	Volume (packed)	Gross weight	Width	Depth	Height including legs (minimum)	Height including legs (maximum)	Net weight
920 mm	1,190 mm	2,390 mm	2.62 m ³	190 kg	830 mm	1,087 mm	2,205 mm	2,255 mm	173 kg

Disclaimer: Every effort has been made to ensure that the information contained in this spec sheet is accurate at the time of publishing. Hoshizaki Europe BV assumes no responsibility or liability for typographical errors or omissions or for any misinterpretation of the information within the publication and reserves the right to change without notice.

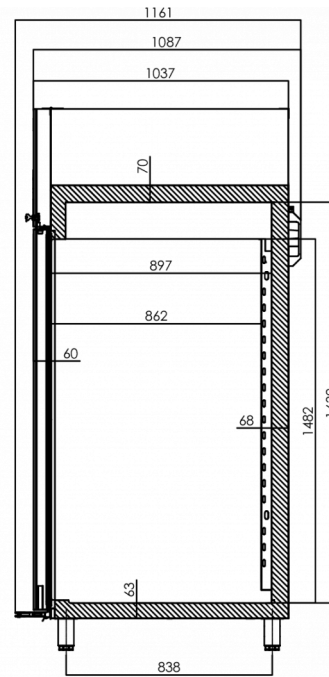
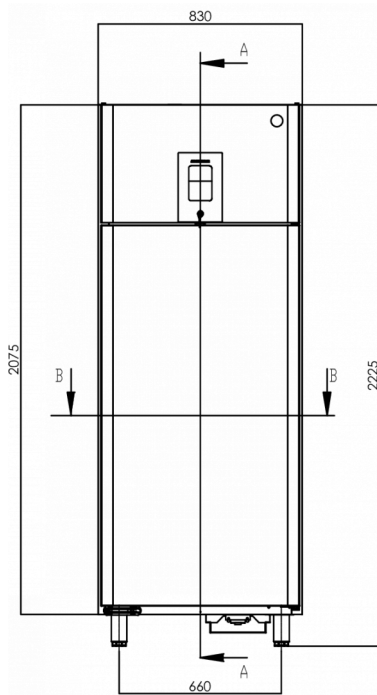

SECTION A-A

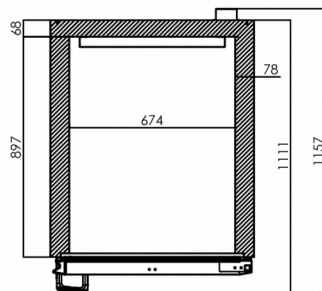

SECTION B-B



HOSHIZAKI

Hoshizaki Belgium
 Hoshizaki Danmark
 Hoshizaki Deutschland
 Hoshizaki France
 Hoshizaki Iberia
 Hoshizaki Italia
 Hoshizaki Middle East

info@hoshizaki.nl
info@hoshizaki.dk
vertrieb@hoshizaki.de
info@hoshizaki.fr
info@hoshizaki.es
commerciale@hoshizaki.it
sales.ex@hoshizaki-europe.com

Hoshizaki Netherlands
 Hoshizaki Norge
 Hoshizaki Sverige
 Hoshizaki UK
 Export countries
 Other countries

info@hoshizaki.nl
salg@hoshizaki.no
orderSE@hoshizaki.dk
uksales@hoshizaki.uk
sales.ex@hoshizaki-europe.com
sales.ex@hoshizaki-europe.com

www.hoshizaki-europe.com