



HOSHIZAKI

Premier K 3 B DL DL DR L E CO2

3-Section Refrigerated Counter without controller (Knockdown) for remote cooling system



PRODUCT SERIES: PREMIER 370
ITEM NUMBER: 311030112102
COUNTRY OF ORIGIN: TURKEY

Hoshizaki Premier K 3 B DL DL DR L E CO2 is a 3-section 1/1 GN refrigerated counter with three doors and an insulation board (no worktop) for built-in under existing tabletop. It has a net usable volume of 288 ltr. The shelf width is 325 mm.

This model is for connection to a remote cooling system and is compatible with R744 (CO2) refrigerant. It does not include factory fitted controller or pressure transmitter. These are the installer's choice. Combine this product with a controller from alternative controller manufacturers.

- For connection to external cooling system and compatible with refrigerant R744 (CO2)
- Prepared for easy integration of installer's preferred controller
- Standard controller display cut-out, size H29 x W71 mm.
- Includes expansion valve
- Fan assisted cooling
- Automatic defrost with re-evaporation of defrost water
- Heavy duty cabinet
- Built for climate class 5 cooling system enduring up to +40°C / 60%RH ambient temperature
- Exterior and interior of stainless steel AISI 304
- Reversible doors
- Anti-tilt shelves
- Removable magnetic door gaskets with triple insulation area
- Pan-shaped inside base with rounded corners to catch fluids
- IP 21 water protection
- Matching design identity as the Premier cabinets



1 / 1 GN

ACCESSORIES INCLUDED

2 grey shelves per door section

OPTIONAL EXTRAS

Set of legs 100-150 mm
Set of legs 125-200 mm
Set of legs 130-180 mm
Stainless shelf, 325 x 530mm
Grey shelf, 325 x 530mm
Shelf supports, 2 of
Door section
Drawer section with 2 x 1/2 drawers
Drawer section with 3 x 1/3 drawers
Flat worktop
Flat worktop with 50mm splashback
Flat worktop with 100mm splashback

WARRANTY PERIOD

1 Year on Parts

EXTERIOR

Stainless steel AISI 304

INTERIOR

Stainless steel AISI 304

Refrigerant compatibility: R744

CERTIFICATIONS





HOSHIZAKI

Premier K 3 B DL DL DR L E CO2

TECHNICAL SPECIFICATIONS

Temperature range	Shelf size	Volume, gross	Power supply	Maximum current amperage	Maximum system pressure	Connection load	Climate class	Ref. capacity (at -10°C)
+2/+12°C	1/1 GN	463 l	230V, 50Hz	2.7 Ah	90 Bar	260 W	S (max. ambient 40°C w/ 40% RH)	250 W

SHIPPING SPECIFICATIONS

Width (packed)	Depth (packed)	Height (packed)	Volume (packed)	Gross weight	Width	Depth	Height	Height including legs (minimum)	Height including legs (maximum)	Net weight
1,835 mm	820 mm	985 mm	1.48 m ³	98 kg	1,751 mm	680 mm	750 mm	880 mm	930 mm	88 kg

Disclaimer: Every effort has been made to ensure that the information contained in this spec sheet is accurate at the time of publishing. Hoshizaki Europe BV assumes no responsibility or liability for typographical errors or omissions or for any misinterpretation of the information within the publication and reserves the right to change without notice.

Please observe: This counter for connection to remote cooling system is on special order only. Please take longer lead times into consideration

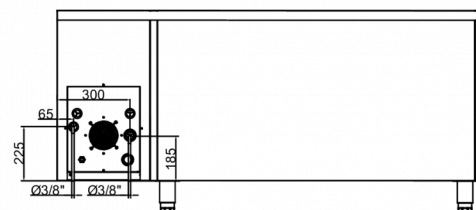
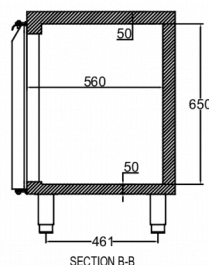
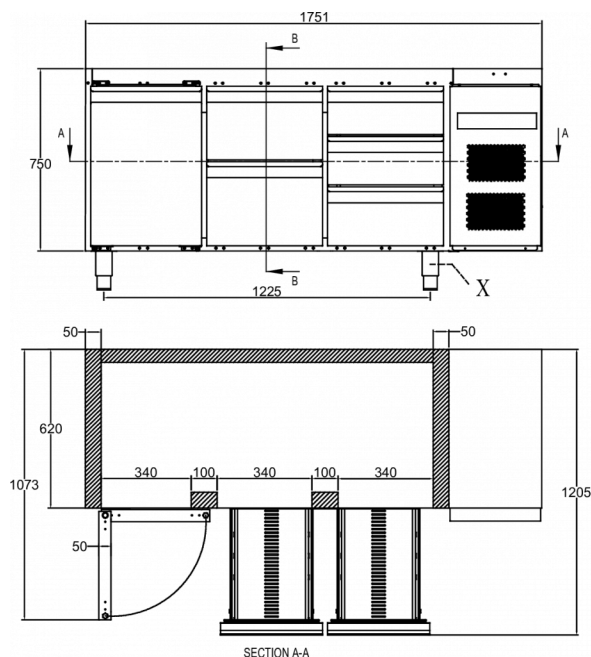

OPTIONS			
700	700	700	700
50	100	100	1.2
X	100	100	100

* PLINTH Model measurements are reviewed without "X" option
* 3 mm MDF Plate should be consider with tabletop models.



HOSHIZAKI

Hoshizaki Belgium
Hoshizaki Danmark
Hoshizaki Deutschland
Hoshizaki France
Hoshizaki Iberia
Hoshizaki Italia
Hoshizaki Middle East

info@hoshizaki.nl
info@hoshizaki.dk
vertrieb@hoshizaki.de
info@hoshizaki.fr
info@hoshizaki.es
commerciale@hoshizaki.it
sales.ex@hoshizaki-europe.com

Hoshizaki Netherlands
Hoshizaki Norge
Hoshizaki Sverige
Hoshizaki UK
Export countries
Other countries

info@hoshizaki.nl
salg@hoshizaki.no
orderSE@hoshizaki.dk
uksales@hoshizaki.uk
sales.ex@hoshizaki-europe.com
sales.ex@hoshizaki-europe.com

www.hoshizaki-europe.com